

# 3900 Metal Toggle Switches 16A 250Vac - IP67 Sealed Versions



ATS3900BAC000

- ▶ Metal toggle switches
- ▶ Ratings up to 20A, 277V ac
- ▶ Single and double pole
- ▶ Choice of circuits including 3 position and momentary
- ▶ Sealed version supplied complete with gaskets
- ▶ Panel seal version to IP67
- ▶ 6.3mm terminals
- ▶ Guard option

## Approvals and specifications



16(4)A 250Vac T85 (3900 & 3950)  
10(4)A 250Vac T85 (All other circuits)



UL CSA\* 20A 125/277Vac (ON-OFF Circuits)  
UL CSA\* 16A 125/277Vac (Other Circuits)  
UL CSA\* 7A 72Vdc, 14A 36Vdc  
UL 250Vac 1hp, 125Vac 1/2hp  
UL 65°C, file E45221, CSA file LR10990

Approvals and ratings vary with function.  
3mm contact gap except where marked  $\mu$ .  
Technical data on pages 4 & 5.  
\* CSA approval for A and B bodies only

toggle switches

ATS 3900 B A C 000

Function Actuator Body Terminal Options

TERMINAL	FUNCTION	ACTUATOR	
<b>C</b>  6.3 x 0.8  Other terminals to special order	<b>Single pole</b> 	<b>B</b>  metal  Metal toggle finish is nickel plate	
	<b>3900</b>  ON - OFF		<b>Double pole</b>  <b>3950</b> 
	<b>3901</b>  ON - OFF (momentary ON)		<b>3951</b> 
	<b>3902</b>  ON - OFF (momentary OFF)		<b>3952</b> 
	<b>3910</b>  ON - ON		<b>3960</b> 
	<b>3911</b>  ON - ON (momentary 1 side)		<b>3961</b> 
	<b>3920</b>  ON - OFF - ON $\mu$		<b>3970</b> 
	<b>3921</b>  ON - OFF - ON $\mu$ (momentary 1 side)		<b>3971</b> 
	<b>3922</b>  ON - OFF - ON $\mu$ (momentary 2 sides)		<b>3972</b> 

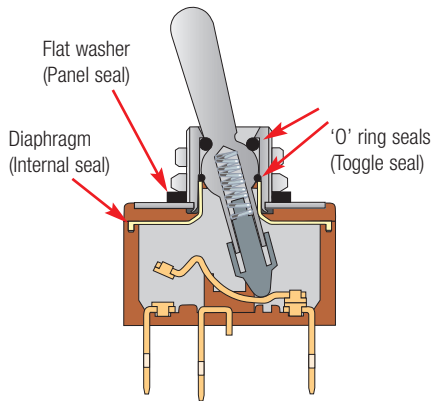

**Toggle switch - sealed version**  
BE and BF types



**Guard R17-10**



ATS3900BEC000



ATS3920BAC000



ATS3950BFC000



ATS3972BBC000

**BODY**

**A**  
Single pole

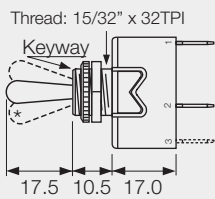

**E**  
Panel sealed, single pole

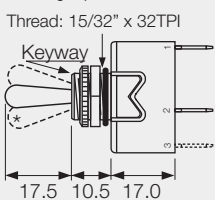

**B**  
Double pole

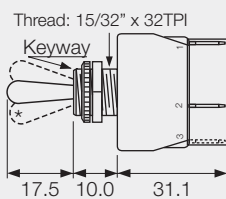

**F**  
Panel sealed, double pole

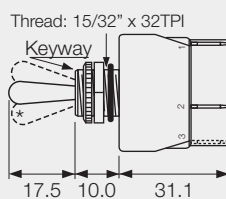

**OPTIONS**

**Neck Seal A0539MOAAA**  
Actuator is visible



**Cover A1080MOAAA**



Covers have internal nylon nuts

**Fixing nuts**

Nickel plated brass are supplied



Hex Back nut

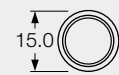

Knurled Front nut  
Panel thickness 4.0 with backnut

**Plate F00232PAAA**  
Plate SP or DP



**DIMENSIONS** (mm) \* Indicates ON position (for ON - OFF switches)

**Single Pole**

(C terminals shown)

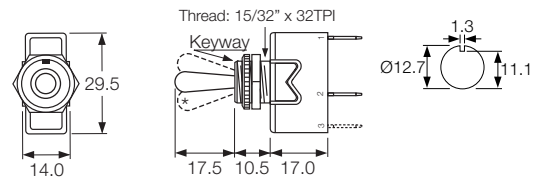

A Body

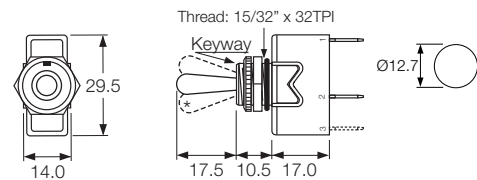

E body (panel sealed)

**Double Pole**

(C terminals shown with barrier)

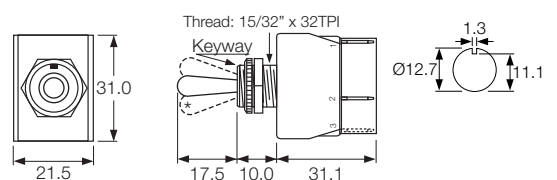

B Body

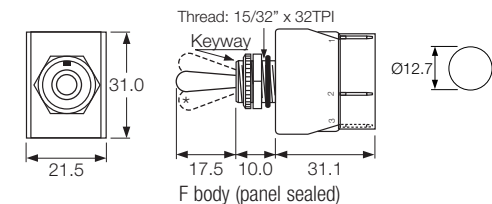

F body (panel sealed)