

ESI11 Vandalproof Pushbutton

19mm

Ø 21.5mm

16.5mm

LED

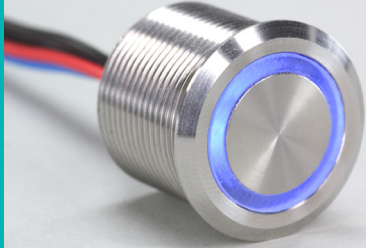

Specification

Termination	15cm flying leads
Switching function	Momentary
Configuration of poles	Single
Maximum load	50mA, 24VDC
LED voltage	See ordering information
Contact resistance	100 mΩ
Insulation resistance	> 100 MΩ
Operating temperature	-20°C to +70°C
Duty cycle	50,000 (min)
Operating force	1.8N
Nut mounting torque	2.5Nm
Panel thickness	1.5 to 13.0mm
Body & button material	Stainless steel & PC
Contact material	Gold

Product Dimensions

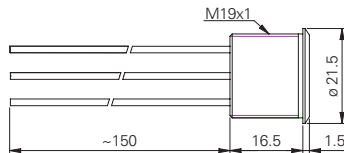

Front view



All dimensions in mm

Engelking

ESI11 Vandalproof Pushbutton

Circuit Diagram

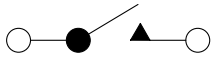

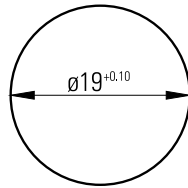

Form A

Mounting Dimensions

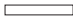

Wiring Instructions

-  Switch wire
-  Switch wire
-  Ground wire for LED
-  LED colour wire for +LED

All dimensions in mm

Ordering information

- | LED-Colour | LED-Voltage |
|-------------------|-------------------------------------|
| BL: Blue | 00: No resistor ¹ |
| GN: Green | 05: 5 volts |
| AM: Orange | 12: 12 volts |
| RD: Red | 24: 24 volts |

ESI11/V2/F/R/ / /M/S/L1

¹ Green & Blue: 3.2 VDC Red & Orange: 2.5 VDC @20mA



Engelking Elektronik GmbH
 Albstr. 16 · D-78609 Tuningen · Germany
 Tel. +49 (0)7464-9865-0 · Fax +49 (0)7464-9865-71
info@engelking.de · www.engelking.de