



E11042 Engelking Inlet C14 double fused



Specification

Power Rating	10A 250V AC
Electric Strength	AC 2.000V for 1 minute
Contact Resistance	30M Ω max.
Insulation Resistance	100M Ω min. at 500V DC
Operating Temperature	+80°C
Materials	Thermoplastic UL Flammability 94V-0 & Copper Alloy
Mounting	F: Flange; S: Snap In; R: Flat Screw On Rear
Termination	Solder Tab (25: 2.5mm; 28: 2.8 mm; 48: 4.8mm; 63: 6.3mm)
Panel Thickness	Snap In; 0.8mm; 1.0mm; 1.2mm; 1.5mm (customized thickness possible)

Product Dimensions

All dimensions in mm

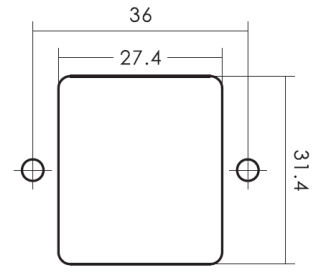
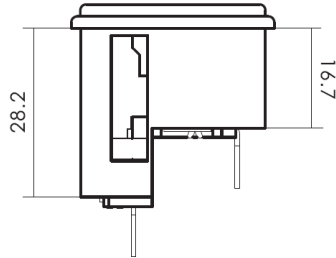
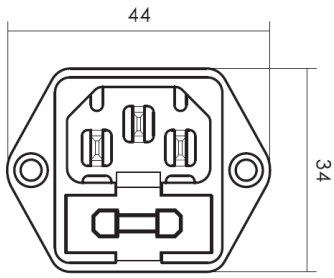

PANEL CUT-OUT

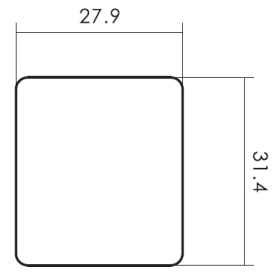
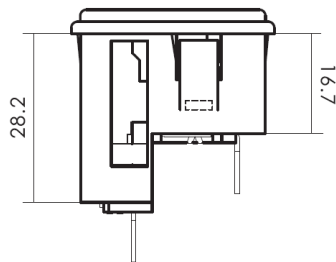
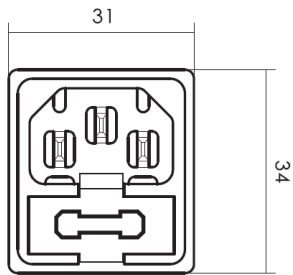

PANEL CUT-OUT

Ordering Information

Panel Thickness¹

00: Flange
08: 0.8mm
10: 1.0mm
12: 1.2mm
15: 1.5mm
30: 3.0mm

Mounting

F: Flange
S: Snap In
V: Vertical Flange²
R: Flat Screw On Rear²

Terminations

25: 2.5mm solder
28: 2.8mm solder
48: 4.8mm solder
63: 6.3mm solder

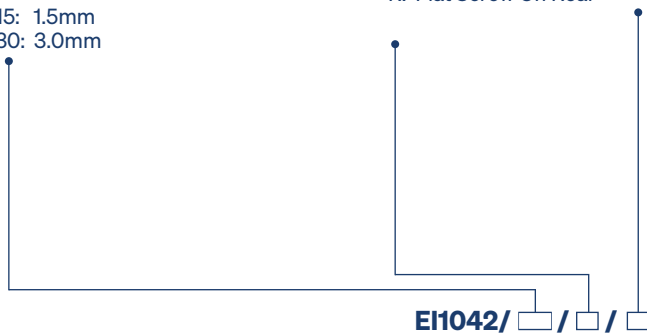

¹ customized thickness possible

² without UL